

NERLITE®

R-100-1 "V2" Series Ring Illuminators

R-100-1 "V2" Series Ring Illuminators feature 36 LEDs (6 more LEDs than the models they replace) in a single ring configuration. Building on the design of our original Ring Illuminators, these models offer enhancements to mounting and accessory installation that make them class leaders in application versatility. Lens adapter options permit direct mounting to lens filter threads. A wide selection of model choices... diffused, non-diffused, or focused - red or white spectrums - 12 or 24 volt power - continuous or strobed... assures broad application coverage. For applications where more light intensity is required, the R-100-2 (two rings of 36 LEDs each for a total of 72 LEDs, p/n 010-6070xx) is available. R-100-1 V2 Ring Illuminators are ideal for applications that require cost-effective illumination of diffused surfaces.

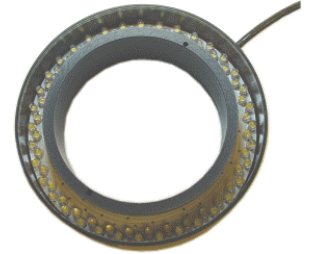

MODEL#	DESCRIPTION
010-6080	R-100-1 V2, R LED 0 = ND, 1 = D 0 = 12V-C, 1 = 24V-C, 2 = 24V-S
010-6080	R-100-1 V2, R LED 2 = F 70, 3 = F 102, 4 = F 127, 5 = F 152 0 = 12V-C, 1 = 24V-C, 2 = 24V-S
010-6080	R-100-1 V2, W LED 0 = ND, 1 = D 3 = 12V-C, 4 = 24V-C, 5 = 24V-S
010-6080	R-100-1 V2, W LED 2 = F 70, 3 = F 102, 4 = F 127, 5 = F 152 3 = 12V-C, 4 = 24V-C, 5 = 24V-S

Description Key

Example: **R-xx-x, R LED-D, 12V-C**

Family Designation: R-xx-x, R LED-D, 12V-C
Outer Diam. (mm) - # of Rings: xx-x, R LED-D, 12V-C

Color:
R = Red
W = White
B = Blue
G = Green
I = Infrared
U = Ultraviolet

Source:
FO = Fiber Optic
FL = Fluorescent
LED = Light Emitting Diode

Voltage (DC):
C = Continuous
S = Strobe

Delivery:
D = Diffused
ND = Non-Diffused
F = Focussed

ACCESSORIES:

Part #	Description	Models Used On
010-901900	SCM-2, 2 Channel Strobe Cntrl.	24V-S
010-501402	CPS-24, 24VDC, US cord	24V-S ¹
010-501401	CPS-24, 24VDC, EU cord	24V-S ¹
010-502601	CPS-24T, 24VDC US w/9-pin D-sub	24V-C & 24V-S ^{1,2}
010-502602	CPS-24T, 24VDC EU w/9-pin D-sub	24V-C & 24V-S ^{1,2}
010-500301	CPS-12 3.5A, 12VDC, US Cord	12V-C
010-500303	CPS-12 3.5A, 12VDC, EU Cord	12V-C
010-502700	ICM-1, M/D Intensity Cntrl, 12V-C	12V-C
010-502701	ICM-1, M/D Intensity Cntrl, 24V-C	24V-C ²
010-502702	SCM-1, 1 Channel M/D Strobe Cntrl.	24V-S
010-501200	VPS, Variable, US Cord	12V-C
010-501201	VPS-EU, Variable, EU Cord	12V-C
030-003702	Ext. Cable, Cont., 1.8 M (6 ft.)	12V-C & 24V-C
030-003703	Ext. Cable, Cont., 3.0 M (10 ft.)	12V-C & 24V-C
030-007006	Ext. Cable, Strobe, 1.8 M (6 ft.)	24V-S
030-007010	Ext. Cable, Strobe, 3.0 M (10 ft.)	24V-S
030-006900	Y cable, 2 Lights, 9 pin D-sub Strb.	24V-S
030-003601	Y cable, 2 Lights, 9 pin D-sub Cont.	12V-C & 24V-C
080-xxxxxx	R-100-1 & -2 Lens Adapters	All

ILLUMINATION & ELECTRICAL:

Lighting Technique: Ring
Light Aperture: 69.5 mm (2.74 in.)
Light Characteristics:

Source	Color (nm)	Exp. Life	Voltage/Current (max.)		
			12V-C	24V-C	24V-S
LED	Red + (660)	50k hrs.	126 mA	69 mA	1.2 A pk.
LED	White - 6500 Kelvin	10k hrs.	240 mA	120 mA	2.4 A pk.

CE Conformity: Yes

MECHANICAL:

OD x ID x H (mm/in.): 101.6 mm x 69.5 mm x 25.4 mm (4.00 in. x 2.74 in. x 1.0 in.)
Mounting: (3) M3 X 3.8 mm (0.15 in.) Deep
Housing Material: Black Anodized Aluminum
Weight: 192.7 grams (6.8 ozs.)

ENVIRONMENTAL:

Max. Operating Humidity: 95% non-condensing
Operating Temp: 40°C (104°F)
Storage Temp: 50°C (122°F)

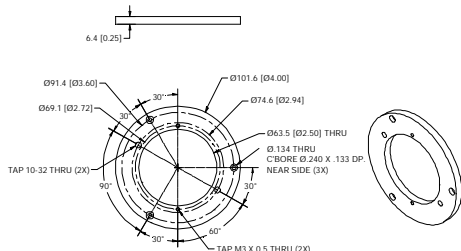

Adapter, R-100 V2 to R-100 V1 Bolt Pattern

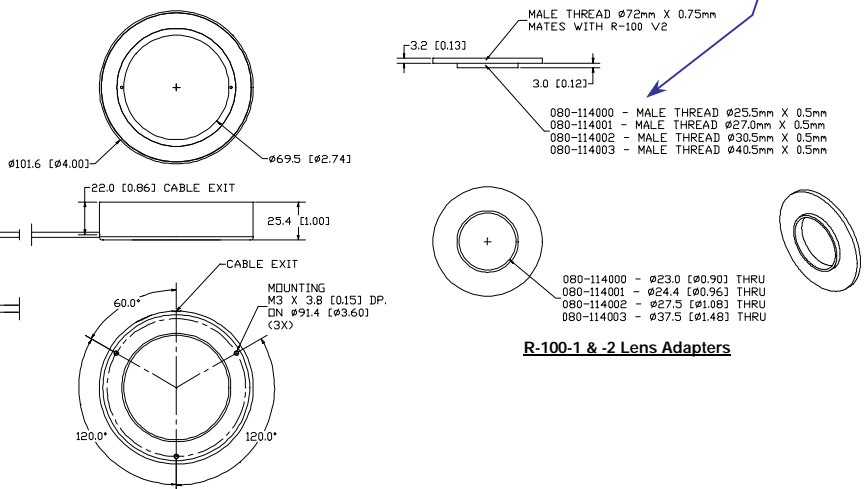

R-100-1 & -2 Lens Adapters

CABLES/CONNECTORS:

	Connector	Length	Pin#	1	2	3	4	5	6	7	8	9
12V-C Models	9 pin D-sub Male	2.0 M (6.6 ft.)		n/a	n/a	GND	+12VDC	n/a	n/a	n/a	n/a	n/a
24V-S Models	9 pin D-sub Male	2.0 M (6.6 ft.)		V-	n/a	n/a	+24VDC	n/a	n/a	n/a	n/a	n/a
24V-C Models ¹	9 pin D-sub Male ¹	2.0 M (6.6 ft.)		n/a	n/a	n/a	n/a	n/a	n/a	+24VDC	n/a	GND

¹Note: 24V-C Models w/"Flying Leads" have a 4.5 M (15 ft.) cable with two (2) tinned leads and no connector; leads are labeled GND and V+ (+24VDC)



Products are protected under US Patent #s:
5,461,417; 5,187,611; 5,539,485; 5,301,402;
5,604,550; 5,684,530; 5,713,661

All RVSI/NER Products come with an Industry-Leading 2-Year Warranty